



OPW

Oifig na
nOibreacha Poiblí
Office of Public Works

BRÚ NA BÓINNE

Welcome to Brú na Bóinne, Newgrange and Knowth

You are doing the Brú na Bóinne Tour plus Newgrange Chamber
There are 3 parts of your trip to Brú na Bóinne



1. Brú na Bóinne Visitor Centre

This is where you collect your tickets

There is an exhibition with lots of information

There is a café and gift shop



2. Newgrange

It is a 5000 year old tomb

One of our guides will bring you inside

It can be claustrophobic for some people inside



3. Knowth

Knowth is a 5000 year old tomb like Newgrange only much bigger

There are also lots of smaller tombs around the big one

There are more exhibitions here

Where are we?

The Visitor Centre is beside Donore village in county Meath

The Visitor Centre is about 3km from the monuments

We will bring you on our shuttle buses to see the monuments

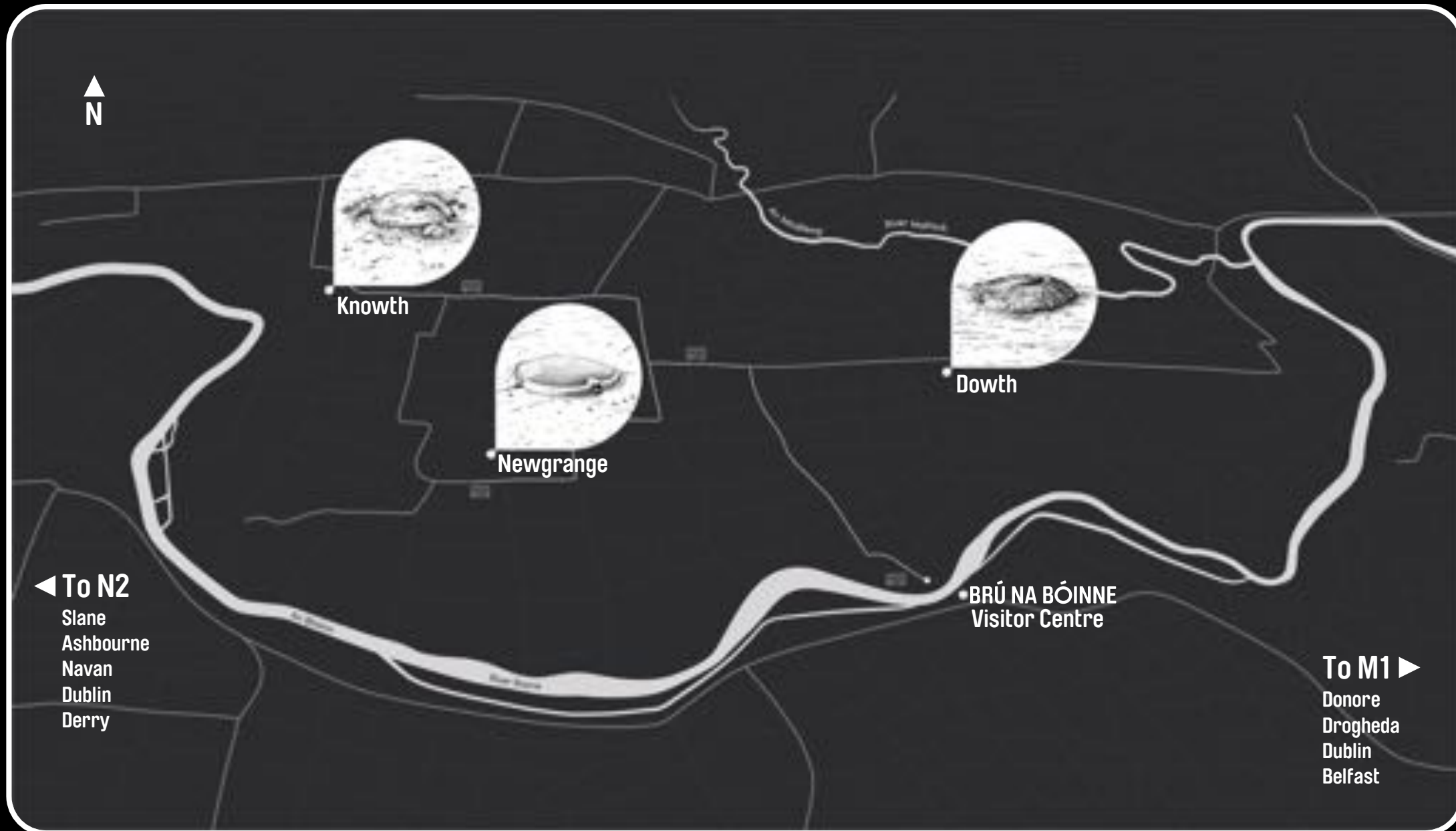

In this story we'll learn about how to enter Brú na Bóinne Visitor Centre, Newgrange and Knowth. You will also find out what to expect to see during your visit.



The Entrance to the Carpark

The entrance to the carpark is beside these flags



The entrance for cars is on the left



In the carpark there is a covered pergola path

If you follow this path it will lead you to the entrance of the visitor centre

This path is 250 long and will take 5 minutes to walk



The Entrance

There is a map and some helpful information on this pathway



This is the entrance to the visitor centre

The doors here are automatic



You will meet some of our friendly guides



This is the reception area

There are 2 desks for collecting tickets

One of our guides will help you here

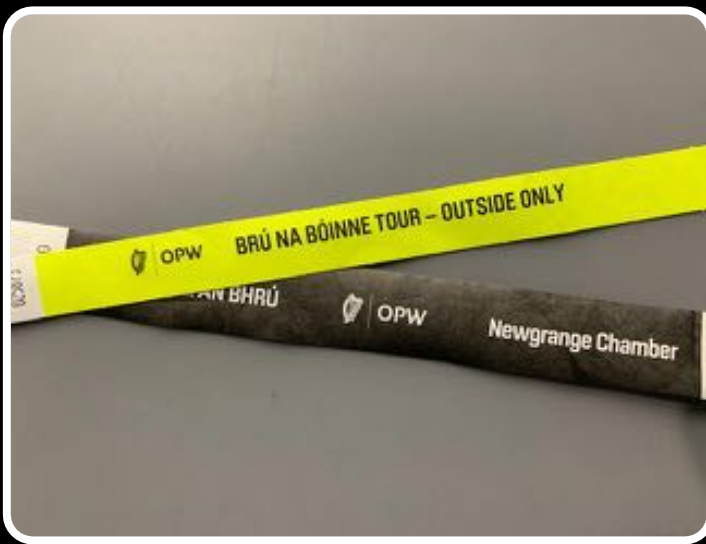

The Reception

Make sure you have booked your tickets online before you visit

When you collect your tickets you will get a wristband.

You must wear this during your visit



The Exhibition

The exhibition is behind the reception area

It will tell you all about Brú na Bóinne



The Exhibition includes:

- Written information
- Photographs, animations & illustrations
- Audio visuals
- An interactive seasons game
- Sounds from the Stone Age
- Flashing images (you can avoid this area)
- A replica of the passage and chamber at Newgrange





Downstairs in the Visitor Centre

There is a café



A Gift Shop



A Boyne Valley sites of interest map and film



A temporary exhibition area



Way out to Monuments

These are the doors you will use to get to the monuments

It is 300m from these doors to the bus stop

It will take about 7 minutes to walk

You can push these doors open



This is the bridge over the River Boyne



Follow the path after the bridge and it will lead you to the bus stop





The Bus Stop

The bus stop is almost hidden from view



This is where you wait for your bus

There are no toilets at the bus stop



The time of your bus is on your ticket

There will be other people waiting here to visit the sites with you



The Brú na Bóinne Buses

The bus will bring you to Newgrange first and then Knowth

The bus journey from here to Newgrange is about 7 minutes

Our drivers will be happy to help if you need any assistance here



Newgrange

You will be here for about 45 minutes



This is the entrance gate to the site

The bus will drop you beside it



Walk up this path to the green building

This is where you will meet your guide



This is the entrance to Newgrange

There are some steps to climb to go inside

A guide will bring you and the other members of the group inside



You will have to leave bags in one of these containers

Your guide will lock it to keep it safe



The passage inside is narrow and low in places

It is safe inside but you don't have to go inside if you feel uncomfortable

There are lights in the passage and chamber



This is the chamber inside Newgrange

The guide will turn off the lights to show you what it is like when the sun shines in on winter solstice



The toilets at Newgrange are across the road from the site

The bus will collect you from Newgrange and bring you to Knowth

This bus journey is about 5 minutes



Knowth

You will be here for about 1 hour



The bus will drop you beside this courtyard

Your guide will meet you here

Here there are 2 buildings



The toilets are in one of these buildings

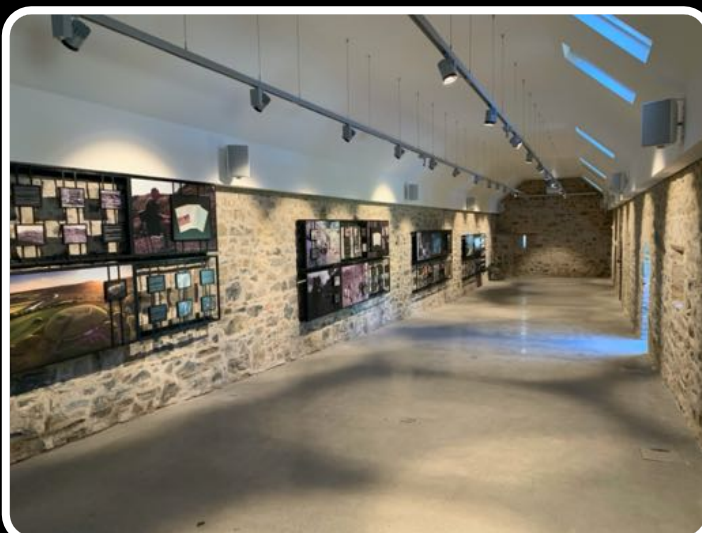

There is an exhibition on excavations at Knowth

There is also a film in this room



The entrance to the site is across the road

A guide will bring you over



This is the site entrance gate



We cannot go inside the original tomb for safety reasons

Your guide will bring the group inside a new modern room and you can look down the passage

You will have to cross this bridge to go inside



View of the entrance to this modern room on the left and the passage is behind the metal gate



In this room there is a VR film showing what it is like to enter the passage and chamber



You can climb to the top of the mound for an amazing view of the Boyne Valley



Knowth is famous for its megalithic art



There are lots of examples of the art to find on the site



You must cross the road again to get your bus back to the Visitor Centre

Look at the other exhibition the courtyard while you are waiting

This exhibition tells you more about the carvings on the stones



The bus will collect you from Knowth and will bring you back to the bus stop again

This is a 7 minute bus journey

When you return to the Visitor Centre, you will enter on the lower level

Go upstairs to find the way out and back to your car



This is the exit or way out of the Visitor Centre

It will bring you to the pergola path you originally came in on

We hope you enjoy your visit to Brú na Bóinne



OPW

Oifig na
nOibreacha Poiblí
Office of Public Works

BRÚ NA BÓINNE