



OPW Oifig na
nOibreacha Poiblí
Office of Public Works

Social Guide

A trip through the National Botanic Gardens, Glasnevin

Introduction

We are going on a trip to the National Botanic Gardens.

It is a garden with lots of beautiful plants and trees and is located in Glasnevin, on the north side of Dublin.

In this story we'll learn about how to enter the Gardens, meet some of the people who work there and find out what we can expect to see during our visit.

The Gardens have two entrances



This is a picture of the main entrance to the Gardens, on Botanic Avenue. If you come by bus or on foot, this is the entrance you will come through



This is a picture of the entrance from the car park. If you come by car or by private bus you will come in this entrance.

We have a one-way system in place in the Gardens at the moment. There are lots of white arrows on the ground, you will see one in the photo above. Follow the arrows clockwise around the Gardens and keep to the left of the paths. You will see lots of signs like this. They have a map on them to show you the way around the Gardens.



Gardens Staff

There are friendly and welcoming people in the Gardens who can help us.

If we can't find our family or friends, we should look for a security officer or a Gardener. As the Gardens are big, sometimes the security guards drive golf buggies.





Café

There is a café for snacks and coffees. It is located in the Education and Visitor Centre. There is a one-way system in place and there may be people queueing with face masks on.



This picture shows the door into the café.

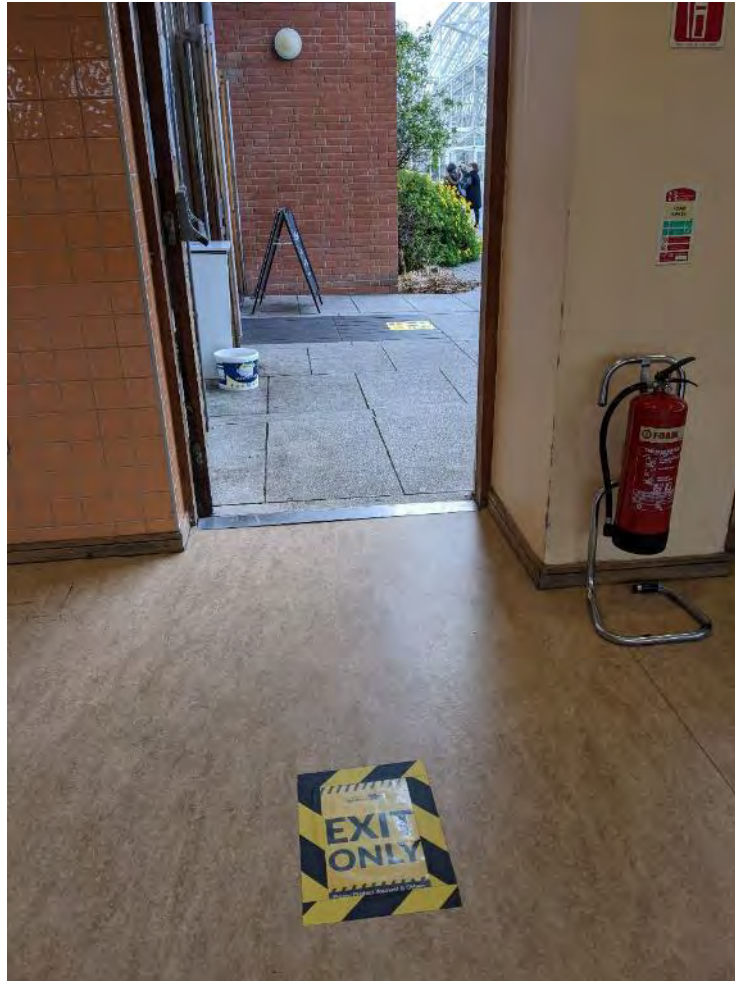

This picture shows the door out of the cafe

Getting Around

The Gardens are a very big space, but we can find our way around by using the Gardens Map and following the signs.

Toilets

There are two sets of toilets in the Gardens. Sometimes there may be a queue of people with face masks on. We may have to wait a little while for our turn.

One set is in the courtyard beside the security hut at the front gate. They are through the grey door.



The other set is in the Education and Visitor Centre. This is the door we go through to go to these toilets. The toilets are on the ground floor.



The Gardens

The Gardens are a large space full of plants and trees. When we go into the Gardens there are a few important things to remember. We will walk slowly and not run in case we fall and hurt ourselves, and we will be very careful not to fall into the water.

We will not pull any leaves of flower off the plants and trees because some of them are very rare and precious.



There is a pond, and the River Tolka running along one side of the Gardens.



We will see lots of wildlife in the Gardens. We will probably see some squirrels. They often come close looking for food but we won't feed them as they may bite.



We will also see some very large Glasshouses. It can get hot and humid inside them and they are full of plants. There are lots of doors to get in and out of the Glasshouses



Leaving the Gardens

We can exit the Gallery via the Main Gate onto Botanic Avenue. There is a one-way system, so go out the gate on the left.



To exit from the Car Park, you go through the Teak House. There are doors on both ends of the Teak House, you can walk straight through.



Everyone is welcome at The National Botanic Gardens.

For more information on our access programme visit

botanicgardens.ie

botanicgardens@opw.ie